

HAWAI'I PACIFIC UNIVERSITY

NEW HEALTH SCIENCE CENTER RELOCATION TO WATERFRONT PLAZA

ROOM CRITERIA

SIMULATION ROOM

| | |
|----------------------|-----------------------|
| ROOM TYPE: | SIMULATION ROOM |
| PROPOSED ASF: | Varies, refer to plan |
| CAPACITY: | Varies |

| | | |
|------------|-------------------------|---|
| USE | ACTIVITIES | Simulated Patient Care, Training, Evaluation |
| | ACCESS | Faculty, Students, Staff |
| | FREQUENCY/ HOURS | TBD |
| | ADJACENCIES | Visual connectivity to control room, see room adjacencies and test-fits |

| | | |
|------------------------|---------------------------|---|
| CHARACTERISTICS | CEILING HEIGHTS | Existing, Confirm 8'-0" |
| | CEILING TREATMENTS | Acoustical Ceiling Tile |
| | FLOOR FINISH | Resilient Sheet Flooring |
| | WALL FINISH | Painted gypsum board / Dry Erase Wallcovering or Panels |
| | NATURAL LIGHTING | N/A |
| | CASEWORK | |
| | ACCESSORIES | Gloves, Sharps Container, Soap, Paper Towel |
| | HARDWARE | |
| | OTHER | Two-way mirror to control room, privacy curtain as required |

| | | |
|-------------------|-----------------------|---|
| TECHNOLOGY | AUDIO/ VISUAL | (4) Wide Angle ceiling mounted PTZ Cameras (1) at the head of bed, (1) at the foot of bed, (1) full room shot, and (1) in Pre-patient room area. Ceiling mounted microphone for talk-back to control room and CAE Learning Spaces Sim Capture. (1) head wall. Ceiling mounted loudspeaker for talkback from control room. (2) Wall-mount confidence flat panel display patient monitors. Confirm equipment with HPU |
| | NETWORK | Wi-Fi, wall mounted data ports |
| | COMMUNICATIONS | patient bedside phone |
| | VENTILATION | Heating/Cooling |

| | | |
|--|----------------------------|---|
| MECHANICAL, ELECTRICAL & PLUMBING | ELECTRICAL | Wall mounted power |
| | ARTIFICIAL LIGHTING | Direct multifunction fixture with exam light function. |
| | PLUMBING / GAS | (1) headwalls for simulation (except at LDR room which requires 2), Gooseneck, Handwashing sink; compressed air and suction, ventilators - Confirm headwall requirements with HPU |

| | |
|---------------------------------|--|
| EQUIPMENT AND FURNISHING | Stretcher, bedside table, overbed table, Optional Patient / Guest Chair, nurse call, Also see room diagram |
|---------------------------------|--|

| | |
|----------------|--|
| REMARKS | Special requirements for mannequin, provide headwall requirements - coordinate with HPU. |
|----------------|--|

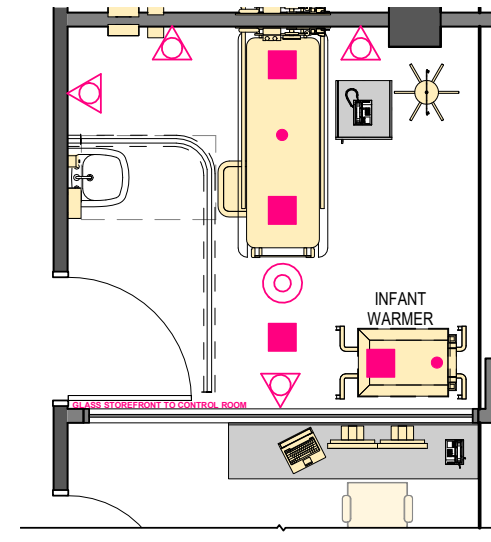
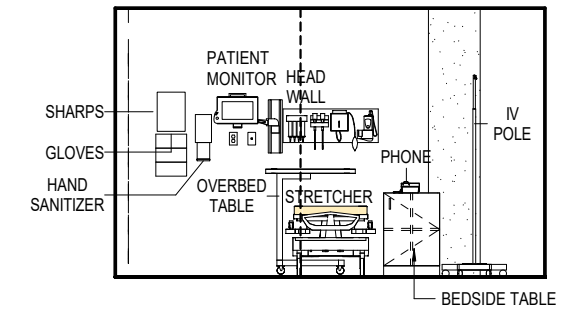

SD, PTD, AND GLOVES DISPENSER AT EACH SINK

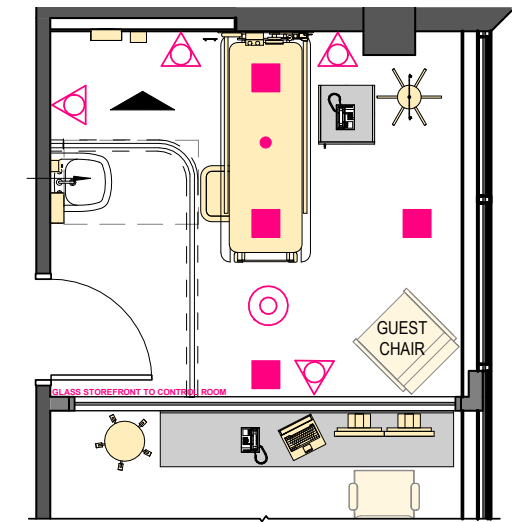

LEGEND

- CEILING MOUNTED SPEAKER
- FLOOR MOUNTED POWER+DATA
- CEILING MOUNTED MICROPHONE
- CEILING MOUNTED CAMERA
- COMPUTER
- WALL MOUNTED CAMERA
- WALL MOUNTED SPEAKER
- WALL MOUNTED POWER+DATA
- AV WALL PLATE
- AV FLOOR BOX
- EQUIPMENT CRENZNA
- FIXED
- MOBILE
- FLAT SCREEN MONITOR
- WHITEBOARD/WRITABLE WALL
- PROJECTION SCREEN
- SHORT THROW PROJECTOR
- 6'-0" x 6'-0" GRID TO REPRESENT INFRASTRUCTURE LOCATION OPTIONS (POWER/DATA/AV/IT) IN CEILING AND FLOOR AS REQUIRED